G20 HYBRID IP

Defender Series



Product parameters

Optical system

Source: Philips Platinum 21R, 470W

Fixture CT: 6700K

Lamp life expectancy : 1,500h

Fixture output: 20,000lm

Movement

Pan: 540 ° /630 ° optional(16 bit)

Tilt: 270 ° (16 bit)

Auto X/Y repositioning

Color system



CMY+CTO color mixing

1 Color wheel: 14 dichroic filters + open

Gobo system

1 Rotating gobo wheel: 8 interchangeable gobos + open. Gobo OD: 16.6mm

1 Static gobo wheel: 14 indexable gobos + open

1 Animation wheel

Effects

Motorized focus

Zoom range: beam mode: 2.1 ° -21.5 ° ,Spot mode: 2.5 ° -29 ° ,Wash mode :
4 ° -31.5 °

Auto focus

2 Rotating prisms: 4 linear + 8 facet,dynamic prism morph

Frost

Dimming: 0-100% linear dimming

Shutter: mechanical with various speed

Protection rating

IP65 (IP66 optional)

Display

Battery operated for fast addressing, 15 seconds standby auto lock

Pan/tilt disengage (hold Left arrow and Right arrow buttons)

Software

Upgrade with DMX and USB as optional

Remote reset DMX address and fixture by DMX

Run time of fixture and light source

3 Control channel modes: 26/24/37 CH

Control

Input signal isolation

Auto thermal protection circuit



Optional installed wireless receiver

Art-Net control

RDM protocol

Electric parameter

AC100-240V, 50/60Hz

Power: 750W

Dimension and weight

Product dimension: 463x331x800mm

Packing dimension (carton): 560x465x920mm

Net weight: 41.1kg

Gross weight (carton): 47.5kg

Colours/ Gobos

:

COLOR WHEEL: 

ROTATING GOBO WHEEL: 

Dimensions

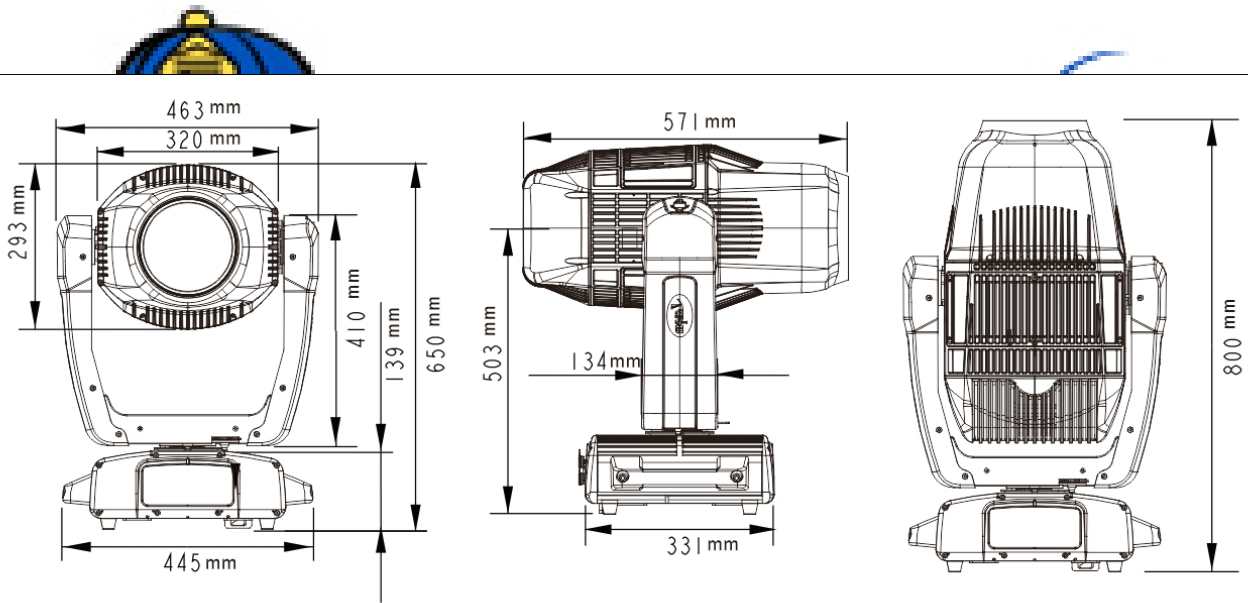

Photometrics

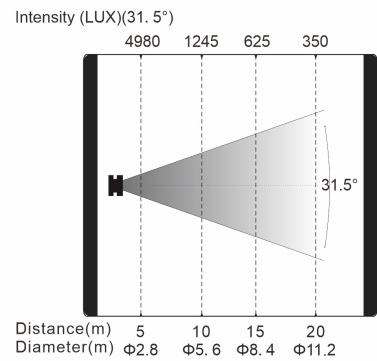
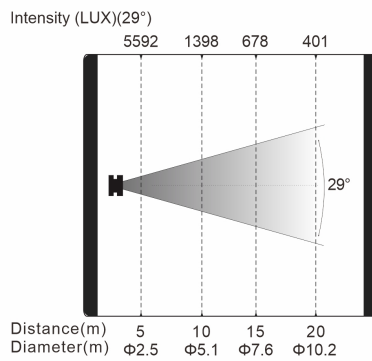
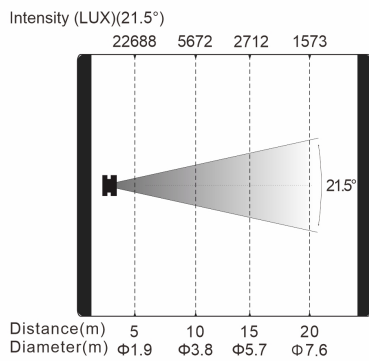
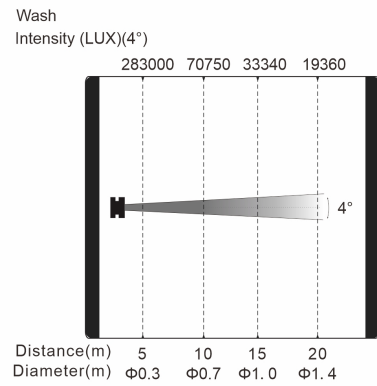
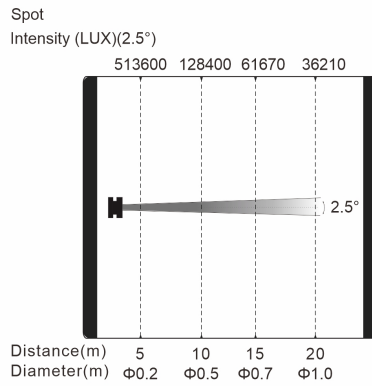
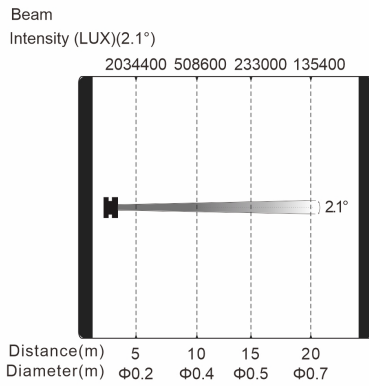



Errors and omissions are possible. All specifications are subject for change without prior notice.