

PTB-2R BEAM



Product parameters

OPTICS

Lamp: Philips Platinum 2R, 100W

CT: 6500K

Life: 10,000H

MOVEMENT

Pan movement: 540 ° /630 ° optional (16 bit)

Tilt movement: 270 ° (16 bit)

Advanced motion system: auto repositioning, fast, quiet and smooth

COLORS

1 Color wheel: 13 dichroic filters + open

GOBOS

1 Static gobo wheel: 14 + open

FEATURES

Rotating prism: 8 facet prism + frost filter

Shutter: mechanical, variable from 1-25Hz or random

Dimmer: 0%-100% linear dimming

Beam angel: 4 °

DISPLAY

Battery operated for fast
addressing

Pan/ Tilt disengage (hold MENU and ENTER button

SOFTWARE

Upgrades: fast and convenient using uploader over DMX

Remote reset DMX address, lamp control, fixture reset, sound control by DMX

Run time of lamp and fixture

3 Control channel modes: 12/10/16 channels

OTHER SPEC

Input signal isolation

Auto thermal protection circuit

RDM compatible

POWER

AC100-240V, 50/60HZ

DIMENSIONS AND WEIGHT

Packing dimension: 51x40.5x36.5cm

Net weight: 10kgs

Gross weight: 13kgs

Colours/ Gobos

COLOR WHEEL: 

STATIC GOBO WHEEL: 

:

Dimensions

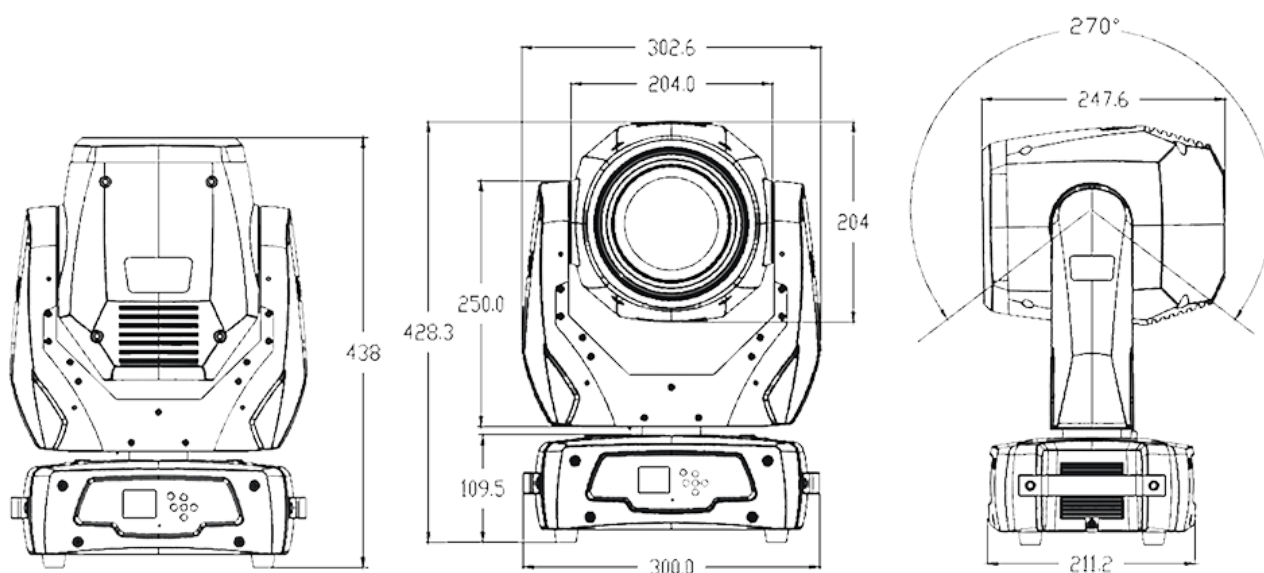

Photometrics

Beam angle 4°

Intensity LUX 42480 18690 10390

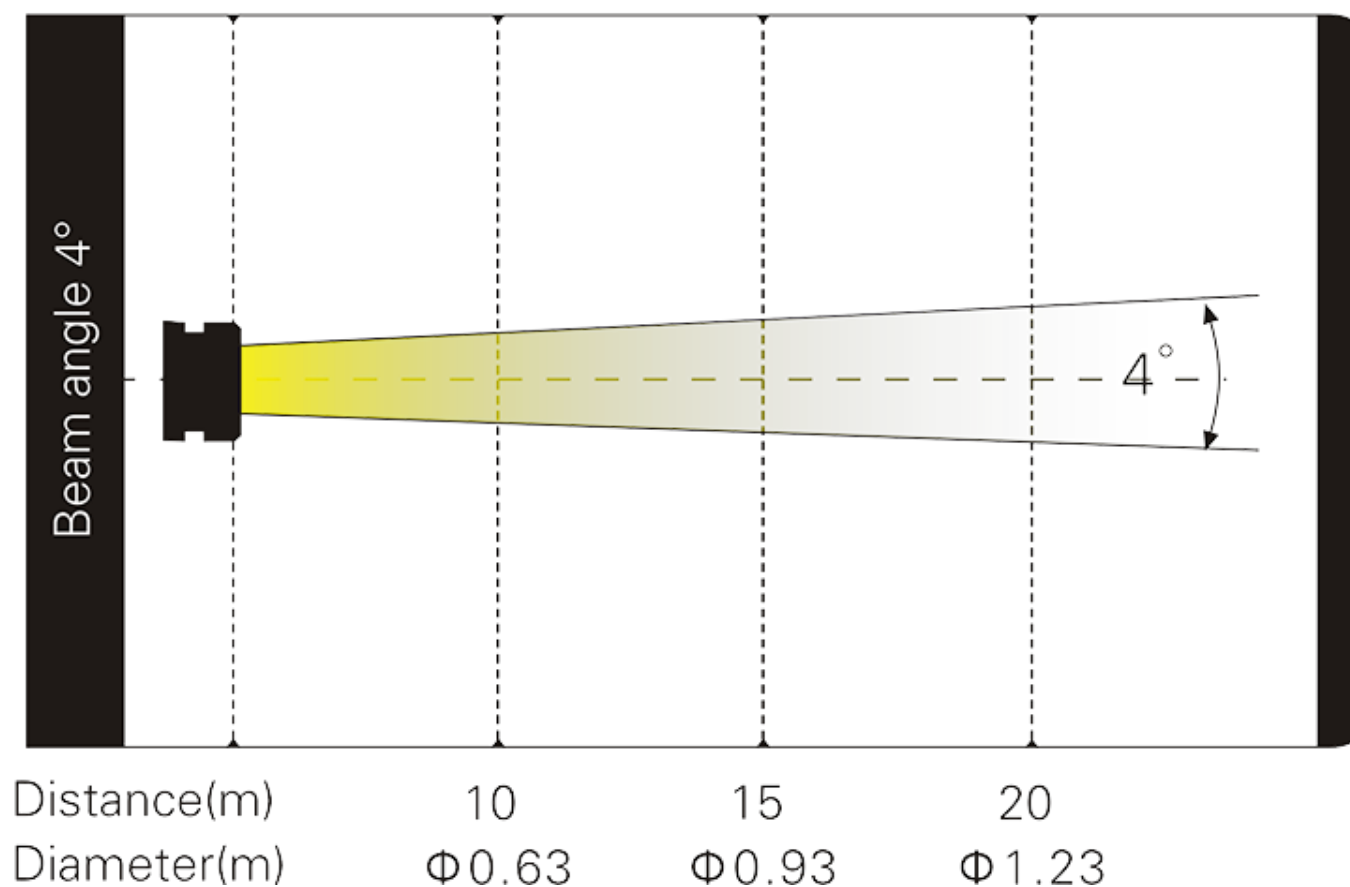

Errors and omissions are possible. All specifications are subject for change without prior notice.